



Quick Installation Guide V1001-PM Pendant Mount for Multi-Sensor Cameras

XX304-61-00

Vicon Industries Inc. does not warrant that the functions contained in this equipment will meet your requirements or that the operation will be entirely error free or perform precisely as described in the documentation. This system has not been designed to be used in life-critical situations and must not be used for this purpose.

Document Number: 8009-8304-61-00
Product specifications subject to change without notice.
Issued: 10/2021 Copyright © 2020 Vicon Industries Inc.
All rights reserved.

Packaging



Pendant Mount

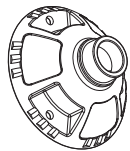

Cap



Quick Guide

Dimensions

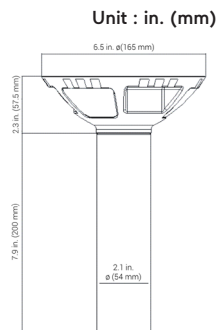

Installation

Step 1. Remove the cap from the accessory package.
According to the 3 hole locations on the cap, bore 3 holes into the installation location and insert 3 expansion bolts into these holes.

Step 2. Use screws to secure cap.

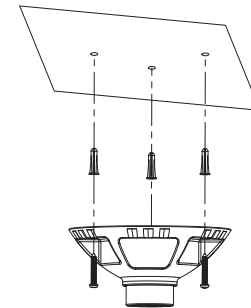

Step 3. Insert pigtail cable into pendant mount bracket and rotate to lock onto camera with screws.

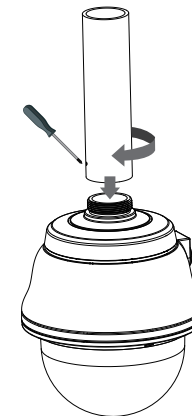

Step 4. Rotate to lock onto camera with screws on the cap.

